



CARIBOO REGIONAL DISTRICT

BYLAW NO. 5116

A bylaw of the Cariboo Regional District, in the Province of British Columbia, to amend Bylaw No. 3100, being the "South Cariboo Area Official Community Plan Bylaw No. 3100, 1995".

WHEREAS the Regional Board may, amend by bylaw an official community plan; and

WHEREAS the Regional Board has in its consideration of this bylaw had due regard to the consideration and requirements of the *Local Government Act*;

NOW, THEREFORE, the Board of Directors of the Cariboo Regional District, duly assembled, enacts as follows:

1. CITATION:

This bylaw may be cited as the "Cariboo Regional District South Cariboo Area Official Community Plan Amendment Bylaw No. 5116, 2017".

2. AMENDMENT

Schedule "B" of Bylaw No. 3100 of the Cariboo Regional District is amended by:

Redesignating Lot 1, District Lots 243 and 3574, Lillooet District, Plan KAP68105 from Agricultural & Parks and Recreation designation to Rural Residential 2 and Agricultural designation and by redesignating part of District Lot 3573, Lillooet District, from Agricultural designation to Rural Residential 2 designation, as shown on Schedule "A".

READ A FIRST TIME this 20th day of October, 2017.

READ A SECOND TIME this 20th day of October, 2017.

A PUBLIC HEARING WAS HELD ON THE _____ DAY OF _____, 2017.

READ A THIRD TIME this _____ day of _____, 2017.

ADOPTED this _____ day of _____, 2017.

Chair

Corporate Officer



I hereby certify the foregoing to be a true and correct copy of Bylaw No. 5116, cited as the "Cariboo Regional District South Cariboo Area Official Community Plan Amendment Bylaw No. 5116, 2017", as adopted by the Cariboo Regional District Board on the day of _____, 2017.

Corporate Officer

SCHEDULE "A"



Legend

-  PROPOSED RURAL RESIDENTIAL 2 DESIGNATION
-  PROPOSED AGRICULTURAL DESIGNATION

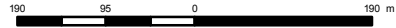

MEASUREMENTS
ARE METRIC

Z17023

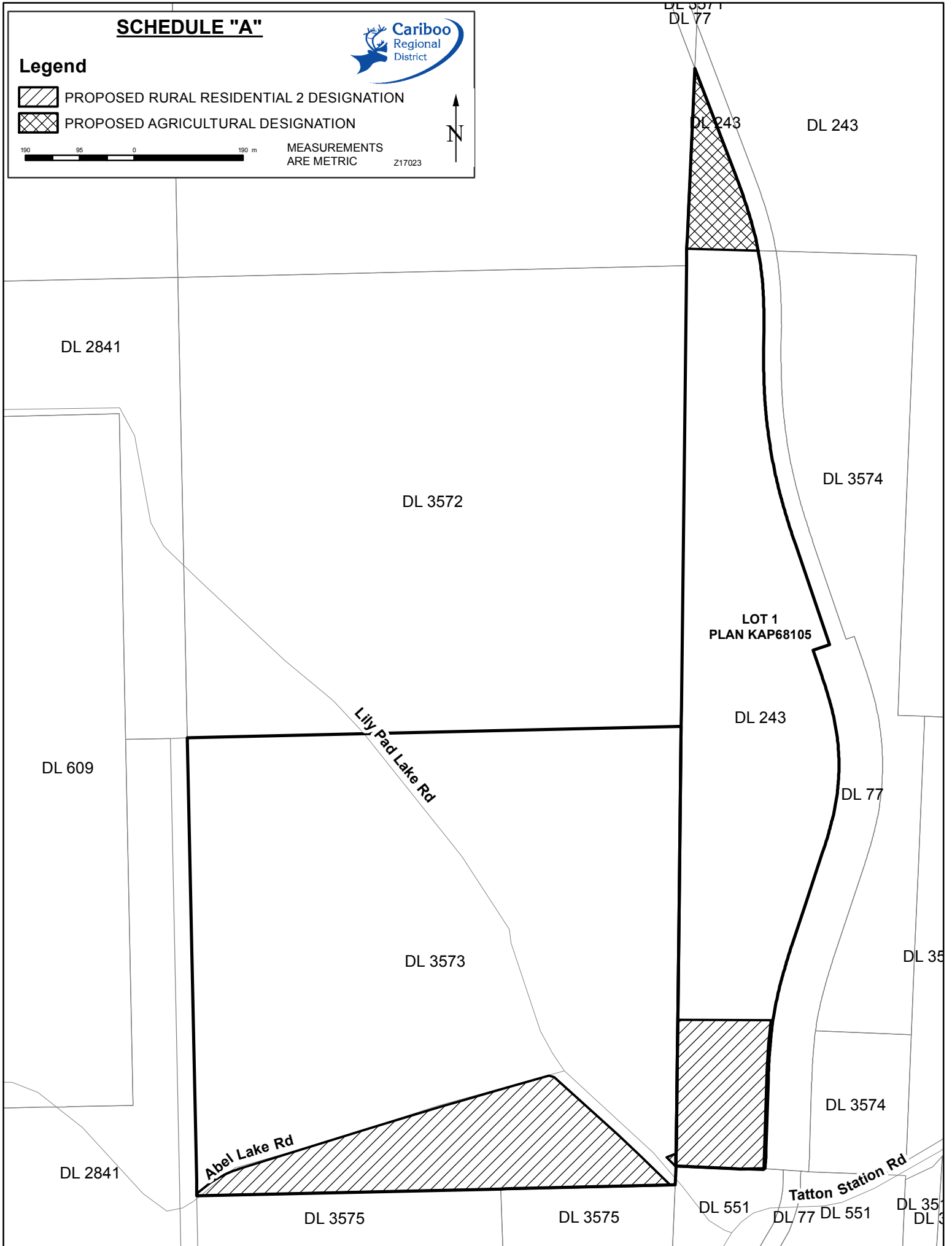



CARIBOO REGIONAL DISTRICT

BYLAW NO. 5117

A bylaw of the Cariboo Regional District, in the Province of British Columbia, to amend Bylaw No. 3501, being the "South Cariboo Area Zoning Bylaw No. 3501, 1999".

WHEREAS the *Local Government Act* authorizes the Regional Board to amend a Zoning bylaw after a public hearing and upon the affirmative vote of the Directors.

WHEREAS an application has been received to rezone property.

NOW, THEREFORE, the Board of Directors of the Cariboo Regional District, duly assembled, enacts as follows:

1. CITATION

This bylaw may be cited for all purposes as the "Cariboo Regional District South Cariboo Area Zoning Amendment Bylaw No. 5117, 2017".

2. AMENDMENT

Bylaw No. 3501 of the Cariboo Regional District is amended by:

- i) rezoning Lot 1, District Lots 243 and 3574, Lillooet District, Plan KAP68105 from Rural 1 (RR 1) and Open Space Parkland (OSP) zone to Rural 2 (RR 2) and Resource/Agricultural (R/A 1) zone, and part of District Lot 3573, Lillooet District, from Resource/Agricultural (R/A 1) zone to Rural 2 (RR 2) zone, as shown on Schedule "A"; and
- ii) amending Schedules "C" and "D" accordingly.

READ A FIRST TIME THIS 20th DAY OF October, 2017.

READ A SECOND TIME THIS 20th DAY OF October, 2017.

A PUBLIC HEARING WAS HELD ON THE _____ DAY OF _____, 2017.

READ A THIRD TIME THIS _____ DAY OF _____, 2017.

ADOPTED THIS ___ DAY OF _____, 2017.

Chair

Corporate Officer



I hereby certify the foregoing to be a true and correct copy of Bylaw No. 5117, cited as the "Cariboo Regional District South Cariboo Area Zoning Amendment Bylaw No. 5117, 2017", as adopted by the Cariboo Regional District Board on the _____ day of _____, 2017.

Corporate Officer

SCHEDULE "A"



LEGEND

-  PROPOSED RESOURCE / AGRICULTURAL (RA 1) ZONE
-  PROPOSED RURAL 2 (RR 2) ZONE

100 95 0 100 m

MEASUREMENTS
ARE METRIC

Z17023



DL 3571
DL 77

DL 243

DL 243

DL 2841

DL 3572

DL 3574

Lot 1
PLAN KAP68105

DL 243

DL 77

DL 609

Lily Pad Lake Rd

DL 3573

DL 35

Abel Lake Rd

DL 2841

DL 3574

DL 3575

DL 3575

DL 551

Tatton Station Rd

DL 77 DL 551

DL 35
DL 3